



MULTI-DECK MERCHANDISER

INSTALLATION & OPERATIONS MANUAL

BWU-D-D / BWU-RB-D

BAKERY

Table of Contents

| | | | |
|---------------------------------|-------|---------------------------|----|
| Technical References | 2-7 | Pre-Power Checklist | 15 |
| General Information | 8 | Product Load | 16 |
| Installation | 9-11 | Case Cleaning | 17 |
| Case Connections | 12 | Parts Ordering | 17 |
| Lighting & Power Supplies | 13-14 | Appendices | |

To ensure proper functionality and optimum performance, it is **STRONGLY** recommended that Hillphoenix specialty cases be installed/serviced by qualified technicians who have experience working with commercial refrigerated display merchandisers and storage cabinets. For a list of Hillphoenix-authorized installation/service contractors, please visit our website at www.hillphoenix.com. **Hillphoenix cases are for commercial use only.**

IMPORTANT SAFETY INSTRUCTIONS (DANGER - READ ALL INSTRUCTIONS BEFORE USING!) SAVE THESE INSTRUCTIONS

Hillphoenix®

a **DOVER** company





a **DOVER** company

LIABILITY NOTICE

For Cases with Shelf Lighting Systems

Hillphoenix does NOT design any of its shelf lighting systems or any of its display cases with shelf lighting systems for direct or indirect exposure to water or other liquids. The use of a misting system or water hose on a display case with a shelf lighting system, resulting in the direct or indirect exposure of the lighting system to water, can lead to a number of serious issues (including, without limitation, electrical failures, fire, electric shock, and mold) in turn resulting in personal injury, death, sickness, and/or serious property damage (including, without limitation, to the display itself, to the location where the display is situated [e.g., store] and to any surrounding property). DO NOT use misting systems, water hoses or other devices that spray liquids in Hillphoenix display cases with lighted shelves.

If a misting system or water hose is installed or used on a display case with a shelf lighting system, then Hillphoenix shall not be subject to any obligations or liabilities (whether arising out of breach of contract, warranty, tort [including negligence], strict liability or other theories of law) directly or indirectly resulting from, arising out of or related to such installation or use, including, without limitation, any personal injury, death or property damage resulting from an electrical failure, fire, electric shock, or mold.

P079211M, REVO

Important

At Hillphoenix®, the safety of our customers and employees, as well as the ongoing performance of our products, are top priorities. To that end, we include important warning messages in all Hillphoenix installation and operations handbooks, accompanied by an alert symbol paired with the word "DANGER", "WARNING", or "CAUTION".

All warning messages will inform you of the potential hazard; how to reduce the risk of case damage, personal injury or death; and what may happen if the instructions are not properly followed.



Revision History

- new manual format_03/21
- technical references, BWU-D-D diagrams and parts list_05/21
- technical references_01/23
- requested compliance changes_07/24

BWS-B

Self-Service Open Multi-Deck Crusty Bread Merchandiser w/ Bins
48", 60", 72", 96", 120", & 144" (Bakery)

GENERAL NOTES:

- "----" Indicates that the feature is not an option on this case model and/or the data is not yet available at this time.

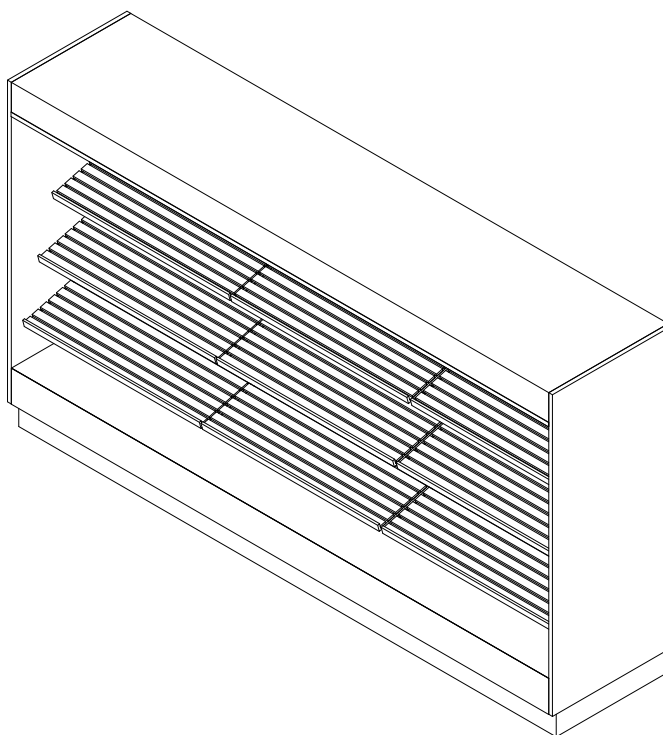

| SHIPPING WEIGHT | |
|-----------------|--------|
| Case | Weight |
| BWS-B | --- |



ENGINEERED FOR STORES WITH AMBIENT CONDITIONS NOT TO EXCEED 75° AND 55% RELATIVE HUMIDITY. DUE TO ENGINEERING IMPROVEMENTS SPECIFICATIONS MAY CHANGE WITHOUT NOTICE. ALL MEASUREMENTS ARE TAKEN PER ASHRAE-72 SPECIFICATIONS. NUMBERS ARE BASED ON STANDARD CASE SIZES. CONSULT ENGINEERING.

BWS-B

| Rev. Date | Rev. # | Rev. Title |
|-----------|--------|---------------|
| 03-15-22 | 2 | DATA UPDATE |
| 05-07-21 | 1 | NEW STANDARDS |



BWS-B

Self-Service Open Multi-Deck Crusty Bread Merchandiser w/ Bins
48", 60", 72", 96", 120", & 144" (Bakery)

| LIGHTING DATA | | | | | | |
|---------------|----------------|--------------|---|-------|-------------------------|-------|
| Case Length | Lights Per Row | Light Length | Clearvoyant 4 LED Lighting (Per Light Row) | | | |
| | | | Standard Power (Cornice or Shelf) | | High Power (Cornice) | |
| | | | 120 Volts | | 120 Volts | |
| | | | Amps | Watts | Amps | Watts |
| 48" | 1 | 4' | 0.05 | 5.9 | 0.12 | 14.9 |
| 60" | 1 | 5' | 0.06 | 7.5 | 0.15 | 18.5 |
| 72" | 2 | 3' | 0.08 | 9.4 | 0.20 | 23.8 |
| 96" | 2 | 4' | 0.10 | 11.8 | 0.24 | 29.8 |
| 120" | 2 | 4' | 0.10 | 11.8 | 0.24 | 29.8 |
| 144" | 3 | 4' | 0.15 | 17.7 | 0.36 | 44.7 |



ENGINEERED FOR STORES WITH AMBIENT CONDITIONS NOT TO EXCEED 75° AND 55% RELATIVE HUMIDITY. DUE TO ENGINEERING IMPROVEMENTS SPECIFICATIONS MAY CHANGE WITHOUT NOTICE. ALL MEASUREMENTS ARE TAKEN PER ASHRAE-72 SPECIFICATIONS. NUMBERS ARE BASED ON STANDARD CASE SIZES. CONSULT ENGINEERING.

BWS-B

| Rev. Date | Rev. # | Rev. Title |
|-----------|--------|---------------|
| 03-15-22 | 2 | DATA UPDATE |
| 05-07-21 | 1 | NEW STANDARDS |

Clearvoyant[®]

Hillphoenix
a DOVER company

BWS-B

Self-Service Open Multi-Deck Crusty Bread Merchandiser w/ Bins
48", 60", 72", 96", 120", & 144" (Bakery)

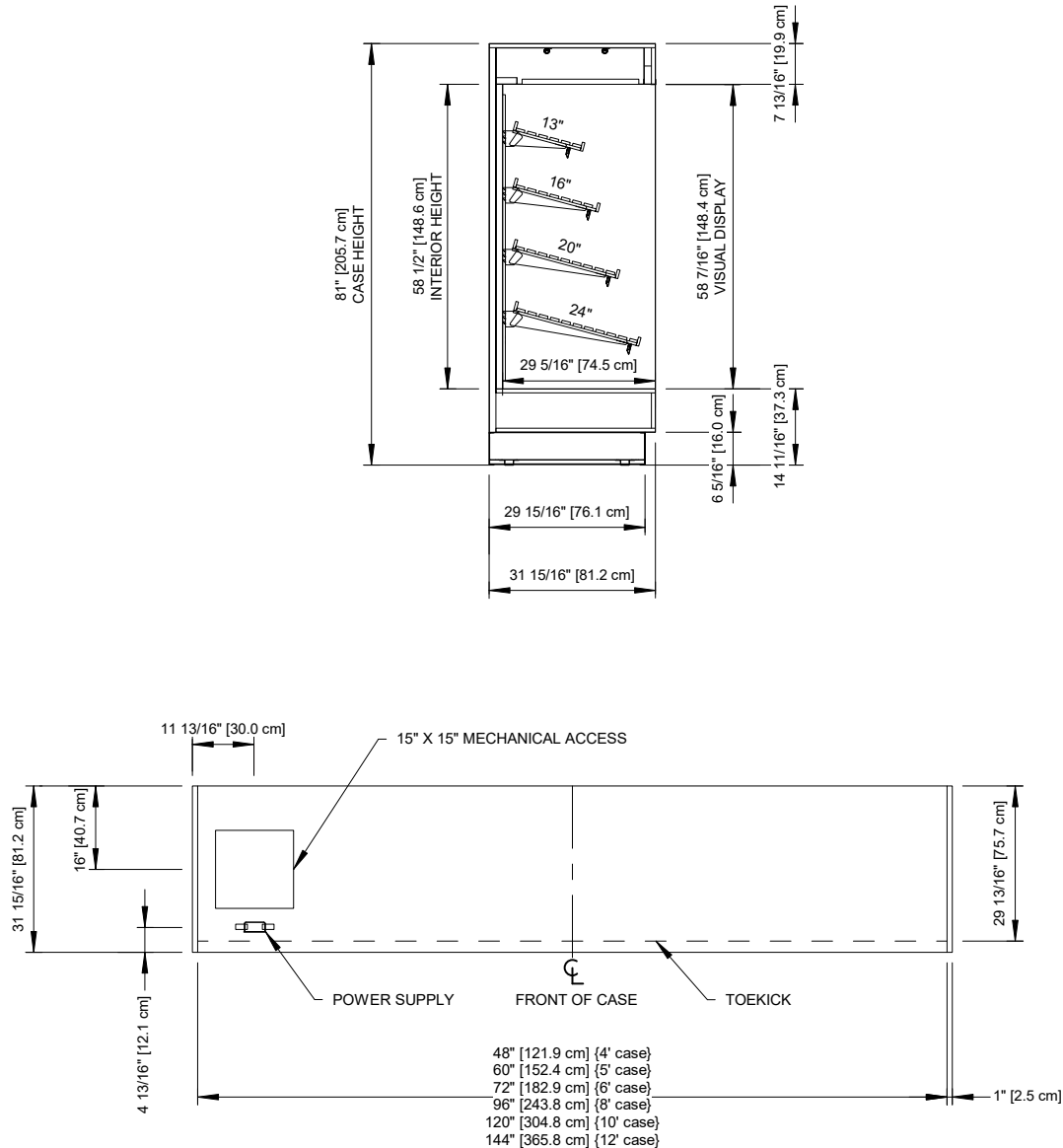

ENGINEERED FOR STORES WITH AMBIENT CONDITIONS NOT TO EXCEED 75° AND 55% RELATIVE HUMIDITY. DUE TO ENGINEERING IMPROVEMENTS SPECIFICATIONS MAY CHANGE WITHOUT NOTICE. ALL MEASUREMENTS ARE TAKEN PER ASHRAE-72 SPECIFICATIONS. NUMBERS ARE BASED ON STANDARD CASE SIZES. CONSULT ENGINEERING.

BWS-B

| Rev. Date | Rev. # | Rev. Title |
|-----------|--------|---------------|
| 03-15-22 | 2 | DATA UPDATE |
| 05-07-21 | 1 | NEW STANDARDS |

Clearvoyant[™] LED SYSTEM

Hillphoenix
a DOVER company

BWS-RB

Self-Service Open Multi-Deck Crusty Bread Merchandiser w/ Bins
48", 60", 72", 96", 120", & 144" (Bakery)

GENERAL NOTES:

- "----" Indicates that the feature is not an option on this case model and/or the data is not yet available at this time.

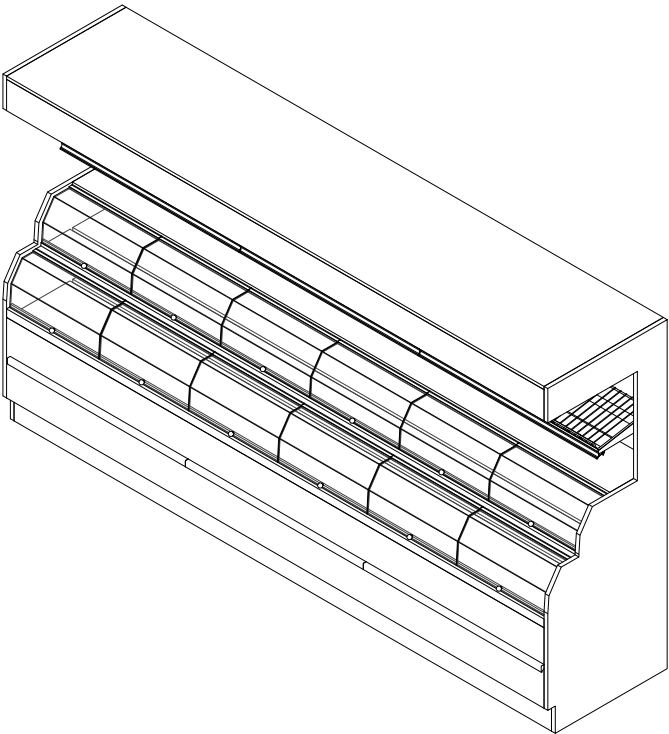

| SHIPPING WEIGHT | |
|-----------------|--------|
| Case | Weight |
| BWS-RB | ---- |



ENGINEERED FOR STORES WITH AMBIENT CONDITIONS NOT TO EXCEED 75° AND 55% RELATIVE HUMIDITY. DUE TO ENGINEERING IMPROVEMENTS SPECIFICATIONS MAY CHANGE WITHOUT NOTICE. ALL MEASUREMENTS ARE TAKEN PER ASHRAE-72 SPECIFICATIONS. NUMBERS ARE BASED ON STANDARD CASE SIZES. CONSULT ENGINEERING.

BWS-RB

| Rev. Date | Rev. # | Rev. Title |
|-----------|--------|---------------|
| 03-15-22 | 2 | DATA UPDATE |
| 04-28-21 | 1 | NEW STANDARDS |



BWS-RB

Self-Service Open Multi-Deck Crusty Bread Merchandiser w/ Bins
48", 60", 72", 96", 120", & 144" (Bakery)

| LIGHTING DATA | | | | | | |
|---------------|----------------|--------------|---|-------|-------------------------|-------|
| Case Length | Lights Per Row | Light Length | Clearvoyant 4 LED Lighting (Per Light Row) | | | |
| | | | Standard Power (Cornice or Shelf) | | High Power (Cornice) | |
| | | | 120 Volts | | 120 Volts | |
| | | | Amps | Watts | Amps | Watts |
| 48" | 1 | 4' | 0.05 | 5.9 | 0.12 | 14.9 |
| 60" | 1 | 5' | 0.06 | 7.5 | 0.15 | 18.5 |
| 72" | 2 | 3' | 0.08 | 9.4 | 0.20 | 23.8 |
| 96" | 2 | 4' | 0.10 | 11.8 | 0.24 | 29.8 |
| 120" | 2 | 4' | 0.10 | 11.8 | 0.24 | 29.8 |
| 144" | 3 | 4' | 0.15 | 17.7 | 0.36 | 44.7 |



ENGINEERED FOR STORES WITH AMBIENT CONDITIONS NOT TO EXCEED 75° AND 55% RELATIVE HUMIDITY. DUE TO ENGINEERING IMPROVEMENTS SPECIFICATIONS MAY CHANGE WITHOUT NOTICE. ALL MEASUREMENTS ARE TAKEN PER ASHRAE-72 SPECIFICATIONS. NUMBERS ARE BASED ON STANDARD CASE SIZES. CONSULT ENGINEERING.

BWS-RB

| Rev. Date | Rev. # | Rev. Title |
|-----------|--------|---------------|
| 03-15-22 | 2 | DATA UPDATE |
| 04-28-21 | 1 | NEW STANDARDS |

Clearvoyant[™]
LED SYSTEM

Hillphoenix
a DOWER company

BWS-RB

Self-Service Open Multi-Deck Crusty Bread Merchandiser w/ Bins
48", 60", 72", 96", 120", & 144" (Bakery)

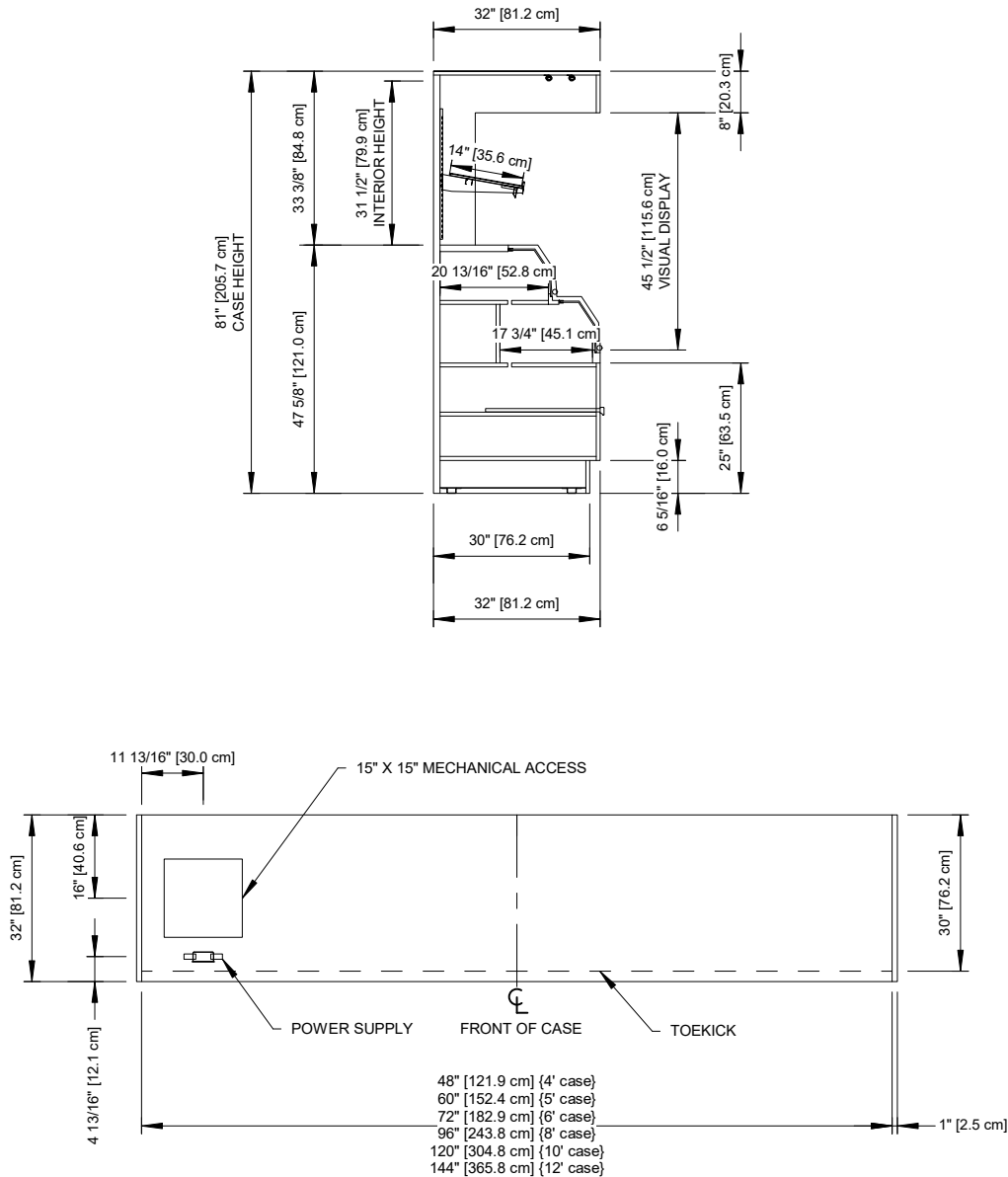

ENGINEERED FOR STORES WITH AMBIENT CONDITIONS NOT TO EXCEED 75° AND 55% RELATIVE HUMIDITY. DUE TO ENGINEERING IMPROVEMENTS SPECIFICATIONS MAY CHANGE WITHOUT NOTICE. ALL MEASUREMENTS ARE TAKEN PER ASHRAE-72 SPECIFICATIONS. NUMBERS ARE BASED ON STANDARD CASE SIZES. CONSULT ENGINEERING.

BWS-RB

| Rev. Date | Rev. # | Rev. Title |
|-----------|--------|---------------|
| 03-15-22 | 2 | DATA UPDATE |
| 04-28-21 | 1 | NEW STANDARDS |

Clearvoyant

Hillphoenix

a DOVER company

GENERAL INFORMATION

Thank you for choosing Hillphoenix for your food merchandising needs. This handbook contains important technical information and will assist you with the installation and operation of your new Hillphoenix specialty cases. By closely following the instructions, you can expect peak performance; attractive fit and finish; and long case life.

We are always interested in your suggestions for improvements (e.g. case design, technical documents, etc.). Please feel free to contact our Marketing Services group at the number listed below. Thank you for choosing Hillphoenix, and we wish you the very best in outstanding food merchandising.

CASE DESCRIPTION

This manual specifically covers the BWU-D-D and BWU-RB-D bakery application self-service multi-deck pastry merchandisers with doors and/or bins.

SHIPPING CASES

Transportation companies assume all liability from the time a shipment is received by them until the time it is delivered to the consumer. Our liability ceases at the time of shipment.

RECEIVING CASES

Examine fixtures carefully and in the event of shipping damage and/or shortages, please contact the Service Parts Department at the number listed below.

CASE DAMAGE

Claims for obvious damage must be 1) noted on either the freight bill or the express receipt and 2) signed by the carrier's agent; otherwise, the carrier may refuse the claim. If damage becomes apparent after the equipment is unpacked, retain all packing materials and submit a written request to the carrier for inspection within 14 days of receipt of the equipment.

Failure to follow this procedure will result in refusal by the carrier to honor any claims with a consequent loss to the consumer.

If a UPS shipment has been damaged, retain the damaged material, the carton and notify us at once. We will file a claim.

LOST/MISSING ITEMS

Equipment has been carefully inspected to insure the highest level of quality. Any claim for lost/missing items must be made to Hillphoenix within 48 hours of receipt of the equipment. When making a claim please use the number listed below.

CASE CERTIFICATION

The certification of the commercial display does not include the products that are on display. These certifications are only in regard to the display case(s) itself.

SERVICE PARTS & TECHNICAL SUPPORT

For service parts questions regarding our cases, please contact our Service Parts Department at 1-844-HPX-PART (1-844-479-7278) or dfr-la-parts@dooverfoodretail.com

For technical questions regarding our cases, please contact our Technical Support Department at 1-833-280-5714.

CONTACTING THE FACTORY

If you need to contact Hillphoenix regarding a specific fixture, be certain that you have both the case model number and serial number. (This information can be found on the data tag, located at the top-left interior, rear exterior panel or interior rear lower storage of the case. *Location may vary based on case design.*)

Hillphoenix Specialty Products
703 Franklin Street, PO Box 478
Keosauqua, IA 52565
Website: www.hillphoenix.com

LOCATION

This display case has been designed for displaying and storing perishable food product. It is engineered for air-conditioned stores with a maximum ambient of 75 °F and 55% relative humidity.

When selecting the location for placement of this case, avoid the following conditions:

Excessive Air Movement

1. Doors
2. Air-conditioned vents
3. Other air sources

Excessive Heat

1. Windows
2. Sun
3. Flood lamps 8 feet or less from the product
4. Other heat sources

FLOOR PREP

1. Ask the general contractor if your current copy of the building dimensions are the most recently issued. Also, ask for the points of reference from which you should take dimensions to locate the cases.
2. Using chalk lines or a laser transit, mark the floor where the cases are to be located for the entire lineup. The lines should coincide with the outside edges of the case feet.
3. Move case as close as possible to its permanent location. Remove all crating and shipping braces above the shipping pallet. Loosen the plastic dust cover from the pallet, but leave cover over the case to protect it while removing the case from the pallet.
4. Shipping braces with a sled runner construction can either have metal brackets that can be removed with a screw gun, or wood blocks that can be removed with a J-bar.
Note: Shipping braces are normally located at each corner of the case. (Shipping braces used vary and are based on case design for best transport.)
5. Carefully, if horizontal supports, lift case up and off the pallet. Remove dust cover. Installation hardware ships in a marked packet located inside the case. Remove dust cover. Installation hardware ships in a marked packet located inside the case.
6. Leveling is necessary. Locate the highest point on the positioning lines as a reference for determining the proper height of the shim-pack levelers. A laser transit is recommended for precision and requires just one person. Level adjustable feet by twisting, if applicable, or shim as necessary under horizontal supports as this will help ensure that the case is not settling over time.

7. Locate horizontal support positions along the chalk line (Fig. 1 & 2). Spot properly leveled shim packs at each support location.



WARNING

Be certain that your hands and feet are out of the way before lowering the case. Failure to do so may result in serious injury.



WARNING

RISK OF SERIOUS INJURY. Keep children away from extended case horizontal or vertical supports (or other similar parts).

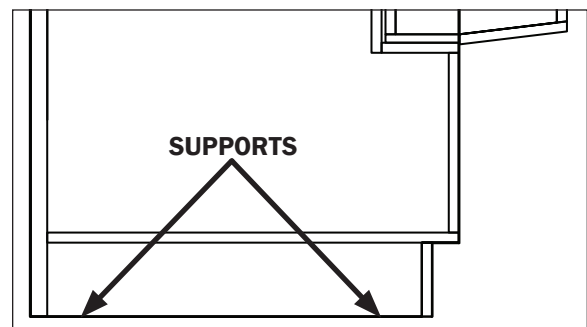

Fig. 1 Horizontal supports (BWU-D-D)

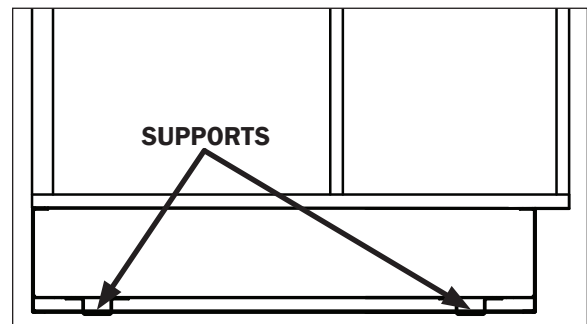

Fig. 2 Horizontal supports (BWU-RB-D)

8. If necessary, drill a hole in each end of every horizontal support (Fig. 3) and fasten to the floor with concrete anchors. **Note: The holes do not need to be in the exact locations specified here. Be sure that the anchors are close to the end of the horizontal supports and at each corner of the case.**

CASE INSTALLATION

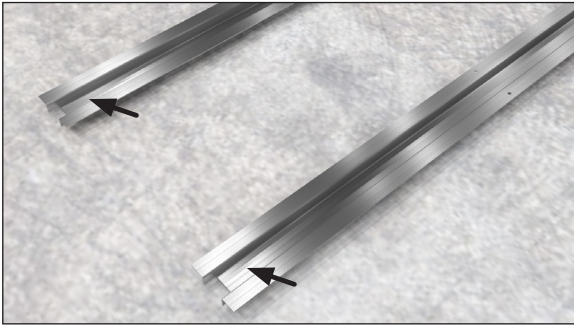

Fig. 3 Seismic anchoring locations

CAUTION

Locate the horizontal supports under unit before removing from pallet. Failure to do so will damage the finished metal if correct lift points are not identified prior to removal.

CAUTION

These cases are not designed for excessive external weight. Do not walk on top or inside of cases. Doing so may result in case damage and/or personal injury.

LINE-UP & INSTALLATION

Single Case

1. Move the case into position. Using a “J” bar, raise the end of the case (under cross support), and lower the horizontal support on to the shim packs. Repeat on the other end of the case.

WARNING

Be certain that your hands and feet are out of the way before lowering the case. Failure to do so may result in serious injury.

WARNING

RISK OF SERIOUS INJURY. Keep children away from extended case horizontal or vertical supports (or other similar parts).

2. Once the case is properly placed on the shim packs, check the horizontal level of the case by placing a bubble level on the rear wall and front sill. Add/remove shim packs as needed.
3. Install the bumper, if applicable, into pre-attached bumper track and snap into place.
4. After sufficient time has passed to allow for bumper shrinkage, cut away the excess bumper for final fit and

finish. Be certain to use an appropriate cutting tool (tubing- or PVC-cutter) to ensure a smooth cut.

5. Install case shelves and reconnect lights. Be aware that differing shelf configurations will affect energy consumption and case performance.
6. Install toekick back onto the base of case.

Multi-Case

1. Remove any shelves (discard the shelf clips) and/or loose items from the cases that may interfere with case joining. Keep all loose items as they will be used later in the installation process.
2. Follow the single-case installation instructions for the first case, excluding #6, then position the next case in the line-up approximately 3' away.
3. Apply a bead of butyl or silicone sealant to the end frame of the first case. From the opposite end, push the second case to a position that is approximately 6" from the first case, then position case on the shim packs.
4. Push the cases tightly together, then lightly bolt them together through the holes provided (Fig. 4 & 5). Tighten all the joining bolts until all margins are equal. Be careful not to over tighten.

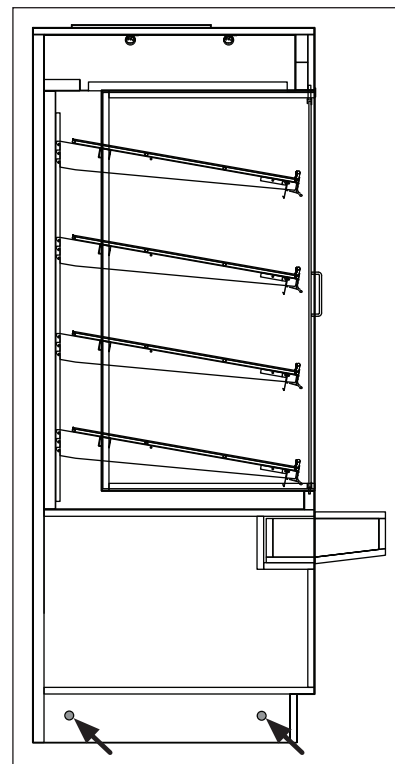

Fig. 4 Bolt locations (BWU-D-D)

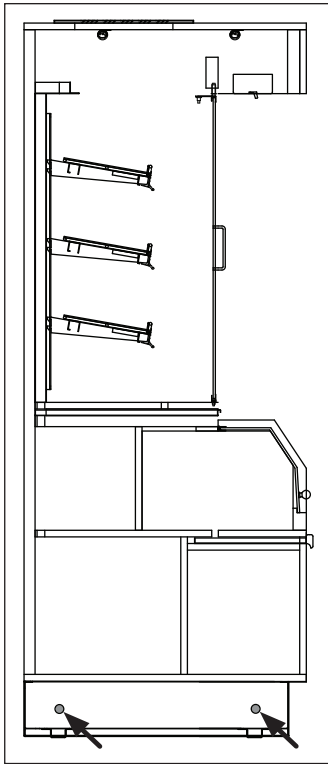

Fig. 5 Bolt locations (BWU-RB-D)

5. Repeat steps 3-5 of this sequence for all remaining cases. Be certain to properly level all cases.
6. Properly align the front panels as needed, then install, if applicable, front panel trim (supplied).
7. Install the bumper into pre-attached bumper track and snap into place.
8. After sufficient time has passed to allow for bumper shrinkage, cut away the excess bumper for final fit and finish. Be certain to use an appropriate cutting tool (tubing- or PVC-cutter) to ensure a smooth cut.
9. Install case shelves and reconnect lights. Be aware that differing shelf configurations will affect energy consumption and case performance.
10. Install toekick back onto the base of case.

CAUTION

Installation of 3rd-party materials may result in diminished case performance.

CASE CONNECTIONS

ELECTRICAL

Electrical hookups are made through the power supply box or electrical raceway that can be accessed by removing the front panel.

For case-to-case wiring, run conduit between the power supply boxes or run wiring through the raceway. When connecting to the power supply on the case, field wiring should exit box from the side furthest away from case wiring to allow more room inside for wiring connections. Always check the data tag located on left end exterior panel or top interior of the case. The case must be grounded. *For more detailed electrical wiring information (see Appendix A1).*



CAUTION

Be certain that all electrical connections are compliant with local codes.



DANGER

CAUTION, RISK OF ELECTRIC SHOCK. If the cord or plug becomes damaged, replace only with a cord and plug of the same type.



WARNING

CAUTION, RISK OF ELECTRIC SHOCK. Connect this case to a properly grounded outlet only. See grounding instructions.

GROUNDING INSTRUCTIONS

For a grounded, cord-connected product rated max 15 amperes and intended for use on a nominal 120-volt supply circuit: This product is for use on a nominal 120-volt circuit and has a grounding plug. Make sure that the product is connected to an outlet having the same configurations as the plug. No adapter should be used with this product.



DANGER

CAUTION, RISK OF ELECTRIC SHOCK.
DANGER - To reduce the risk of electric shock. When using an electrical display, basic precautions should always be followed, including the following: Read all instructions before using (this display).

IMPORTANT SAFETY INSTRUCTIONS

When using an electrical display, basic precautions should always be followed, including the following: Read all instructions before using (this display).

1. Keep the cord away from heated surfaces.
2. Never operate this display if it has a damaged cord or plug, if it is not working properly, if it has been dropped or damaged, or dropped into water. Contact our service parts and/or technical support.
3. Use this display only for its intended use as described in these instructions. Do not use attachments not recommended by the manufacturer.
4. Never drop or insert any object into any opening.
5. Do not use outdoors.
6. **WARNING - Risk of Injury -** Do not operate this display with a remote control or app on a smart device.
7. **WARNING - Risk of Injury to Persons.** Do not use this display to support video equipment such as televisions or computer monitors.

GENERAL LIGHTING INFORMATION

Hillphoenix cases are equipped with LED luminaires and feature specially designed light reflectors in the cornice to improve the illumination of products. LED power supplies operate both the cornice and shelf lights and are located above the cornice reflectors.

The lighting system has an ON/OFF switch located in the raceway, power box or at the inside back of the case. Once a case has been properly positioned in the store and an electrician has connected the lighting circuit, the lights may be turned on to verify that they are connected and functioning properly.

To ensure peak performance, it is advisable to run the lighting systems only when the store climate control is on and case refrigeration is started. **Note: It is highly recommended that the ambient store temperature not exceed 80°F.**



DANGER

SHOCK HAZARD

Always disconnect power to case when cleaning, servicing or configuring components of the lighting system. Failure to do so may result in serious injury or death.



WARNING

Using improper DC power supplies may damage the luminaires, resulting in sub-standard operation and increased chances of safety issues/injury.



WARNING

Never replace a 24V DC power supply with a T8 or T5 ballast of any kind! Ballasts use alternating current (AC) instead of direct current (DC) and operate at a much higher voltage than is used by this LED system. Doing so will damage the LED system and increases the chance of safety issues/injury.

LED DRIVER/POWER SUPPLY ACCESS

To gain access to the LED driver or power supplies remove the front toekick cover (Fig. 6). The power supply can be located at the customer left side of the case. **NOTE: The power supply box will vary from the figure depicted here as the box will be mounted to a slide-out tray laying flat.**

REPLACING LED LIGHTS

Once store power is connected and the light circuit is ener-

gized, the Clearvoyant LED system should operate without the need for any significant maintenance for several years. Should a power supply need to be removed and/or replaced, turn off the power to the case before proceeding. Be certain to replace the power supply with genuine Hillphoenix parts or a comparable UL-listed Class-2 rated regulated 24V DC power supply with 100W output capacity.

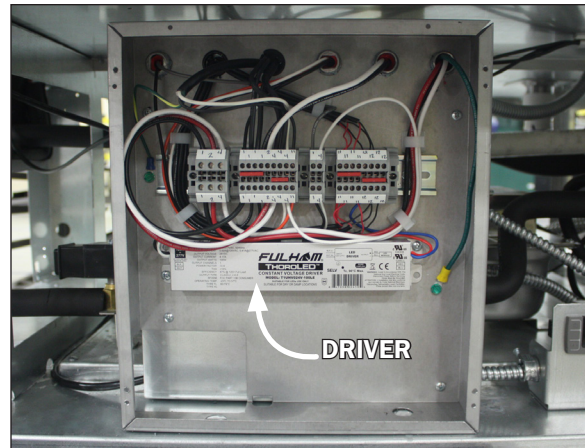

Fig. 6 Clear view of the driver

LED LUMINAIRES

Removing LED luminaires:

1. Unplug the luminaire (Fig. 7).

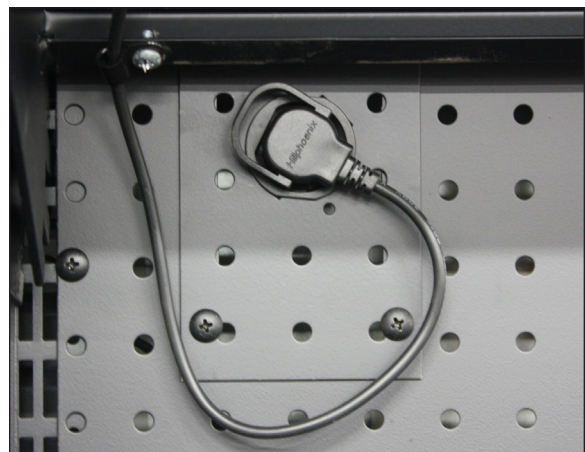

Fig. 7 LED light power cord

2. Remove the screws from the light clamps (Fig. 8) while keeping ahold of the light. Once the screws are removed the light rod will come away from the case with the clamps still holding to the light.



CAUTION

Too much tension on the inner clamp rings while removing them from an LED light rod may cause breakage. Use only enough tension for removal.

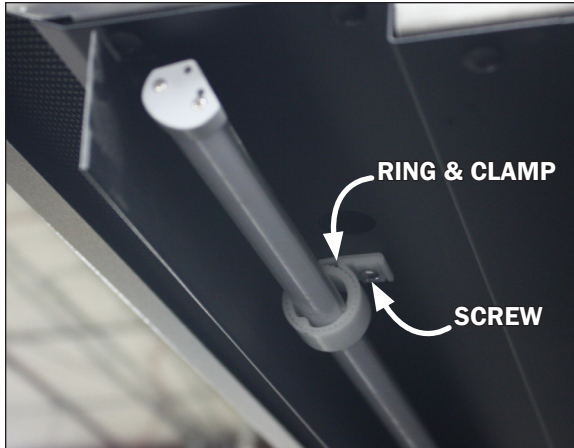

Fig. 8 LED light & ring/clamp

3. Remove the closed clamps and inner rings (Fig. 9) by unclipping the clamp ends located above the screw opening. This will release the grip around the inner ring (Fig. 10) and allow for the two pieces to be separated from one another.

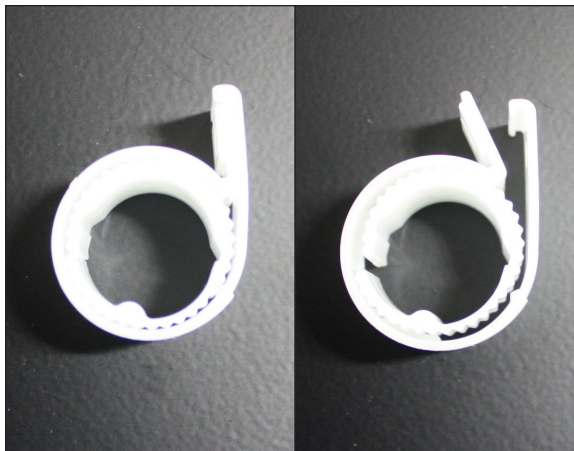

Fig. 9 Closed clamp

Fig. 10 Open clamp

4. Carefully remove the inner rings from around the light rod.

Re-installing LED luminaires:

1. Place a ring (Fig. 11) around each end of the light rod and rotate until both edges of the rod line-up and snap ahold to the ridges in the ring.
2. Slide a clamp (Fig. 11) over each ring and close them tight around the rings by clipping together the clamp ends located above the screw opening.
3. Line-up the closed clamps (Fig. 9) and light rod with the existing screw holes on the case and re-attach.
4. Rotate the light rod into desired position after the clamps are firmly re-attached.



Fig. 11 LED ring and clamp



CAUTION

Luminaires are not intended for use on/ in aquariums and/or installation in plastic cabinets.

Before powering-up the case, be certain that all of the steps listed below have been completed to ensure proper case functionality, safety and compliance with warranty terms.

- ☐ **Have you thoroughly examined the case for shipping damage? (see pg. 8)**
- ☐ **Have you checked the horizontal level of the case? (see pg. 9)**
- ☐ **Have you applied the sealant to the end breakers of adjoining cases? (see pg. 10)**
- ☐ **Have you sealed the case-to-case joints by applying caulk and acrylic tape to the end frame seam? (see pg. 10)**
- ☐ **Have you installed the toekick? (see pg. 10)**

After powering-up the case, be certain that all of the steps listed below have been completed to ensure proper case functionality, safety and compliance with warranty terms.

- 1. Check all lights to ensure they are all functioning properly.**

PRODUCT LOAD

PRODUCT LOAD

Hillphoenix cases provide maximum product capacity within the refrigerated air envelope. Please keep products within the appropriate load limit.

It is important that you do not overload the food product display (Fig. 12 & 13). Overloading will cause case malfunction.

For loading always put heavier items at the bottom and not near the top in order to help prevent the possibility of the display tipping over, if applicable.

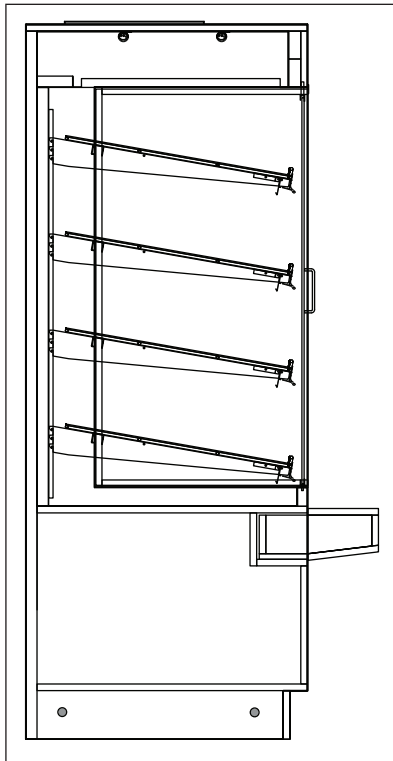

Fig. 12 Product load (BWU-D-D)

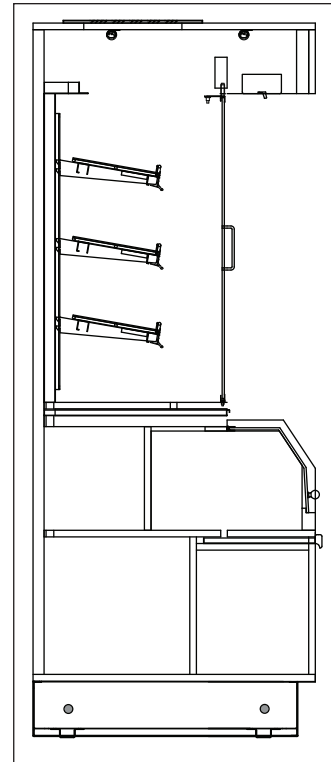

Fig. 13 Product load (BWU-RB-D)



CAUTION

The maximum load weight for each loadbearing surface is 150 lbs. Do not exceed this weight. Doing so may lead to case damage.

CASE CLEANING

A periodic cleaning schedule should be established to maintain proper sanitation, insure maximum operating efficiency, and avoid the corrosive action of food fluids on metal parts that are left on for long periods of time. We recommend cleaning once a week. Further suggestions for case cleaning include the following:

- To avoid shock hazard, be sure all electrical power is turned off before cleaning. In some installations, more than one disconnect switch may have to be turned off to completely de-energize the case. **Always unplug this display from electrical outlet before cleaning.**
- To clean the LED luminaires, shut off the lights in the case, then wipe the luminaires down with a soft, damp cloth. Avoid using harsh or abrasive cleaners as they may damage the lights. Be certain that the luminaires are completely dry before re-energizing.
- Clean from top to bottom when cleaning the display case to avoid cross contamination.
- If any potentially harmful cleaners are used, be certain to provide a temporary separator (e.g., cardboard, plastic wrap, etc.) between those cases that are being cleaned and those that may still contain product.
- Avoid spraying any cleaning liquids directly on the electrical connections.
- Remove toekick and clean underneath the case with a broom and a long-handled mop. Use warm water and a disinfecting cleaning solution when cleaning underneath the cases.



DANGER

SHOCK HAZARD

Always disconnect/unplug power to case when servicing or cleaning. Failure to do so may result in serious injury or death.



WARNING

CAUTION, RISK OF ELECTRIC SHOCK. To reduce risk of burns, fire, electric shock or injury to persons: Unplug from outlet before putting on or taking off parts.

Hillphoenix[®]

a **DOVER** company

Contact the Service Parts Department at:

1-844-HPX-PART (1-844-479-7278)

or

dfr-ia-parts@doverfoodretail.com

Provide the following information about the part you are ordering:

- **Model number and serial number*** of the case for which the part is intended.
- **Length of the part** (if applicable).
- **Color of part** (if painted) or color of polymer part.
- **Whether part is for left or right-hand application.**
- **Quantity**

***Data tag is located on the left end exterior panel or top interior of the case.**

If the parts are to be returned for credit, contact the Parts Department. Do not send parts without authorization.

| | |
|--------------------|---------------------------|
| A1 | Wiring Information |
| B1-B2 | Parts List |

A1: WIRING DIAGRAM

TBD

B1: PARTS LIST (BWU-D-D)

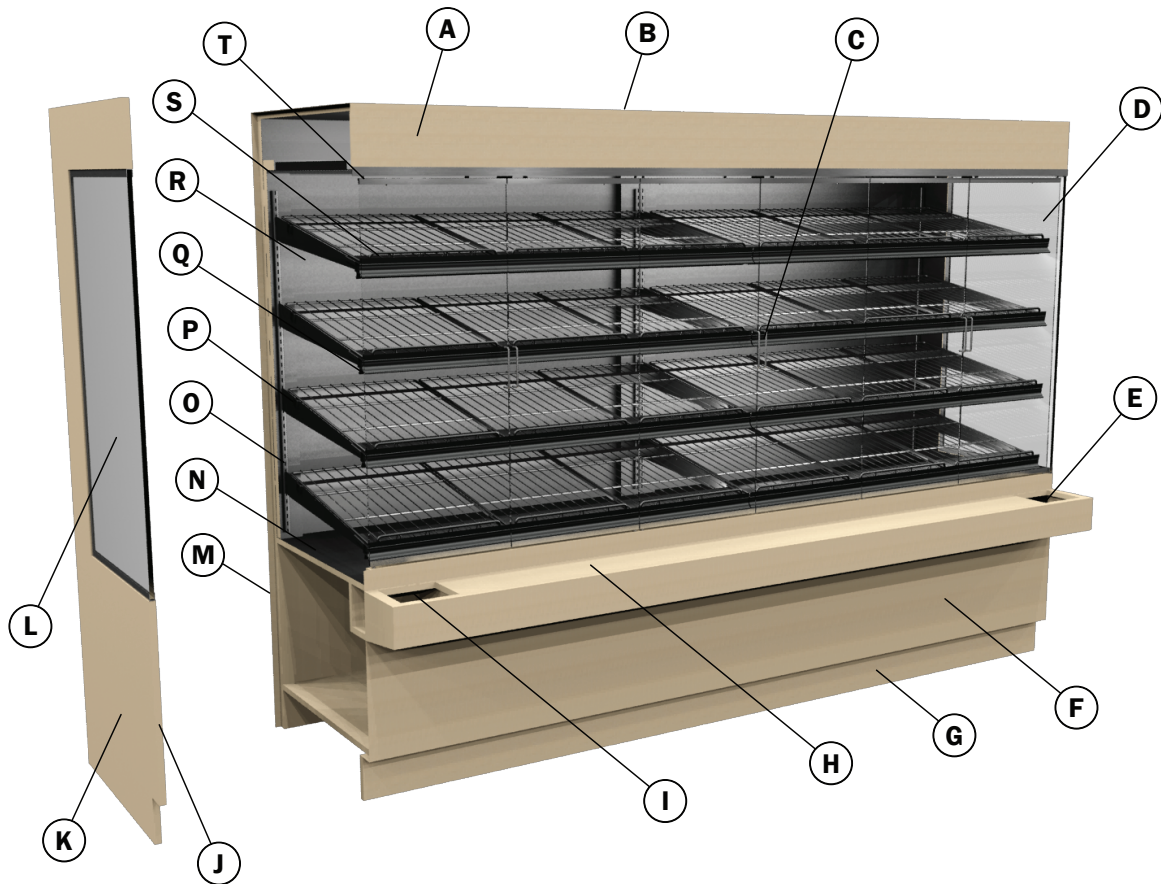

| | |
|----------|---|
| A | Cornice |
| B | Case Top |
| C | Handle Pull |
| D | Front Swing Access Doors |
| E | Tissue Dispenser |
| F | Front Panel |
| G | Front Toekick |
| H | Bread Shelf and Bag Ledge (Optional) |
| I | Bag Cutout (Optional) |
| J | End Panel Trim |
| K | End Panel |
| L | End Panel Glass Insert |
| M | Outside Back |
| N | Inside Base Panel |
| O | Shelf Standard |
| P | Adjustable Wire Shelf Bracket |
| Q | Tag Molding |
| R | Inside Back |
| S | Wire Shelf Product Stop |
| T | Swing Access Door Hardware |

B2: PARTS LIST (BWU-RB-D)

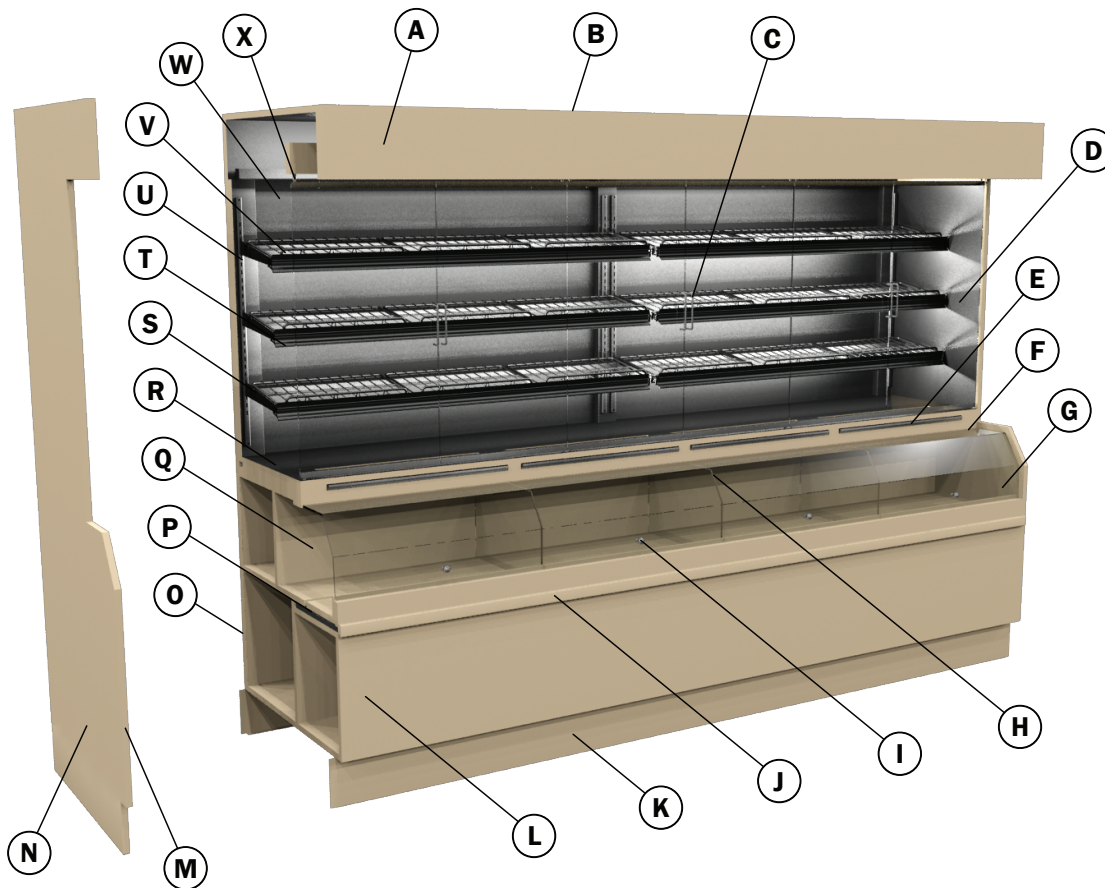

| | |
|----------|--|
| A | Cornice |
| B | Case Top |
| C | Pull Handle |
| D | Front Swing Access Doors |
| E | Upper Crumb Tray |
| F | Lift Plex Bin Door Hinge Hardware |
| G | Front Lift Plex Bin Door |
| H | Plex Bin Dividers |
| I | Pull Knob |
| J | Lower Crumb Tray Pull Handle |
| K | Front Toekick |
| L | Front Panel |
| M | End Panel Trim |
| N | End Panel |
| O | Outside Back |
| P | Lower Crumb Tray |
| Q | Bread Bin |
| R | Inside Base Panel |
| S | Adjustable Wire Shelf Bracket |
| T | Tag Molding |
| U | Shelf Standard |
| V | Wire Shelf Product Stop |
| W | Inside Back |
| X | Swing Access Door Hardware |



Hill PHOENIX, Inc.
Hereinafter Referred To As Manufacturer

LIMITED WARRANTY

GENERAL WARRANTY

Manufacturer's products are warranted to be free from defects in materials and workmanship under normal use and maintenance for fourteen months from date of shipment from manufacturer (the "Base Warranty Period"). In the event of a qualifying warranty claim, a new or rebuilt part to replace any defective part will be provided without charge. The replacement part is covered under this warranty for the remainder of the applicable Base Warranty Period. In order to be eligible for warranty coverage, customer must: (i) notify Manufacturer promptly upon discovery of a warrant defect, and (ii) comply with the warranty claim procedures provided by Manufacturer from time to time.

This equipment warranty does not include labor or other costs incurred for diagnosing, repairing, removing, installing, shipping, servicing, or handling of either defective parts or replacement parts.

The warranty shall not apply:

1. To any unit or any part thereof which has been subject to accident, alteration, negligence, misuse or abuse, or which has not been operated in accordance with the manufacturer's recommendations, or in conditions outside of Manufacturer's specifications, or if the serial number of the unit has been altered, defaced, or removed.
2. When the unit, or any part thereof, is damaged by fire, flood, or other act of God.
3. To products that are impaired or damaged due to improper installation.
4. When installation and startup forms are not properly completed or returned within two weeks after startup.
5. If the defective part is not returned to the Manufacturer.
6. To service, maintenance or wear and tear parts (such as lights, starters and ballasts)

MODIFICATIONS TO GENERAL WARRANTY

The following sets forth certain modifications to the General Warranty for specific products of Manufacturer:

DISPLAY CASE AND SPECIALTY PRODUCTS CLEARVOYANT® LED LIGHTING

The warranty period for Clearvoyant LED lighting components within the Clearvoyant lighting system is five years from date of shipment.

REMEDY LIMITATION/DAMAGES EXCLUSION

THE REMEDY OF REPAIR OR PROVISION OF A REPLACEMENT PART WITHOUT CHARGE SHALL BE THE EXCLUSIVE REMEDY FOR ANY WARRANTY CLAIM HEREUNDER. WITHOUT LIMITING THE FOREGOING, MANUFACTURER SHALL NOT BE LIABLE UNDER ANY CIRCUMSTANCES FOR INCIDENTAL, INDIRECT OR CONSEQUENTIAL DAMAGES, INCLUDING LOSS OF PROFIT, LABOR COST, LOSS OF REFRIGERANT OR FOOD PRODUCTS.

EXCLUSIVE WARRANTY

THE FOREGOING WARRANTY IS THE EXCLUSIVE WARRANTY WITH RESPECT TO THE PRODUCTS. ALL OTHER WARRANTIES, WHETHER EXPRESS OR IMPLIED, INCLUDING WITHOUT LIMITATION, THE WARRANTIES OF MERCHANTABILITY OR FITNESS FOR A PARTICULAR PURPOSE, ARE HEREBY DISCLAIMED AND EXCLUDED. NO IMPLIED WARRANTY SHALL BE DEEMED CREATED BY COURSE OF DEALING OR USAGE OF TRADE. NO OTHER PERSON IS AUTHORIZED TO EXPAND OR CREATE ANY OBLIGATION GREATER THAN OR MORE EXPANSIVE THAN THE WARRANTY PROVIDED HEREIN.

Submit warranty claims to:

Hillphoenix Refrigeration & Power

Systems Division

2016 Gees Mill Road

Conyers, GA 30013

Warranty / Service

Phone: 1-833-280-5714

Hillphoenix Display Case Division

1925 Ruffin Mill Road

Colonial Heights, VA 23834

Warranty / Service

Phone: 1-833-280-5714

Hillphoenix Specialty Products Division

703 Franklin Street

Keosauqua, IA 52565

Warranty / Service

Phone: 1-833-280-5714

Warning

Maintenance & Case Care

When cleaning cases the following must be performed PRIOR to cleaning:

To avoid electrical shock, be sure all electric power is turned off before cleaning. In some installations, more than one switch may have to be turned off to completely de-energize the case.

Do not spray cleaning solution or water directly on fan motors or any electrical connections.

All lighting receptacles must be dried off prior to insertion and re-energizing the lighting circuit.

Please refer to the Use and Maintenance section of this installation manual.

Hillphoenix[®]

a **DOVER** company

Hillphoenix Specialty Products
1-319-293-3777

703 Franklin Street, PO Box 478, Keosauqua, IA 52565

Due to our commitment to continuous improvement, all specifications are subject to change without notice.

Hillphoenix is a Sustaining Member of the American Society of Quality.

Visit our website at www.hillphoenix.com

