

**GENERAL NOTES**

- " - - - " indicates that the feature is not an option with this case model and/or that the data is not available at this time.

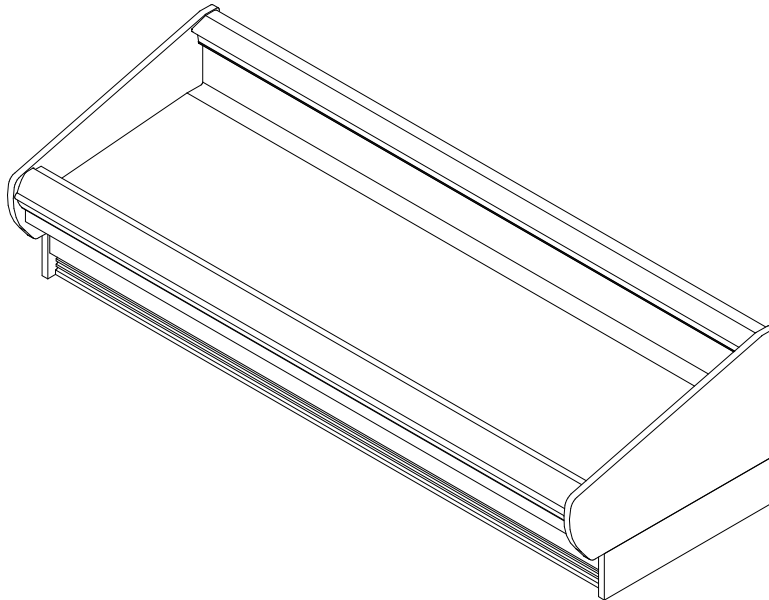

SHIPPING WEIGHT	
Case	Weight
OWP	---



COMPONENT  
ALL MEASUREMENTS ARE TAKEN PER ASHRAE-72-2005 SPECIFICATIONS. HILLPHOENIX REFRIGERATED DISPLAY CASES FOR SALE IN THE UNITED STATES MEET OR EXCEED DEPARTMENT OF ENERGY 2017 REQUIREMENTS.

**OWP**

Rev. Date	Rev. #	Rev. Title
7-31-18	2	NEW STANDARDS
12-1-17	1	DOE 2017

ELECTRICAL DATA									
Case Length	Fans Per Case	High Efficiency Fans		Anti Condensate Heaters		Defrost Heaters			
		120 Volt		120 Volts		208 Volts		240 Volts	
		Amps	Watts	Amps	Watts	Amps	Watts	Amps	Watts
8'	2	0.15	9.2	0.25	30.0	3.85	800	4.44	1065
12'	2	0.15	9.2	0.25	30.0	3.85	800	4.44	1065

LIGHTING DATA						
Case Length	Lights Per Row	Lights Length	Clearvoyant v4 LED Lighting (Per Light Row)			
			Standard Power (Cornice or Shelf)		High Power (Cornice Only)	
			120 Volts		120 Volts	
			Amps	Watts	Amps	Watts
8'	2	4'	0.10	11.8	0.25	29.9
12'	3	4'	0.15	17.6	0.37	44.8

GUIDELINES AND CONTROL SETTINGS							
Application	Rear Sill Heights	BTUH/ft		Superheat Set Point @ Bulb (°F)	Evaporator (°F)	Discharge Air (°F)	Discharge Air Velocity (FPM)
		Conventional	Parallel				
Cut Produce	39"	379	353	6 - 8	26	31	180
Cut Produce	43"	538	501	6 - 8	26	30	210
Bulk Produce	39"	298	277	6 - 8	29	36	180
Bulk Produce	43"	501	466	6 - 8	29	35	210

DEFROST CONTROLS							
Defrosts Per Day	Run Off Time (Min)	Electric Defrost		Timed-Off Defrost		Hot Gas Defrost	
		Fail Safe (Min)	Termination Temp (°F)	Fail-Safe (Min)	Termination Temp (°F)	Fail Safe (Min)	Termination Temp (°F)
2	6 - 8	40	49	60	47	26	45

**NOTES:**

- "---" indicates that the feature is not an option with this case model and/or the data is not yet available.
- Listed discharge air velocity represents the average velocity at the peak of defrost.
- Temperature and defrost settings listed above are recommended start-up settings. Final operational settings may need to be adjusted for the store conditions in which the case operates.
- The recommended evaporator temperatures may need to be adjusted based on system setup, store conditions, etc. The minimum recommended evaporator temperature is 4°F below the listed evaporator temperature.
- Timed off defrost is recommended for medium temperature applications.



ALL MEASUREMENTS ARE TAKEN PER ASHRAE-72-2005 SPECIFICATIONS. HILLPHOENIX REFRIGERATED DISPLAY CASES FOR SALE IN THE UNITED STATES MEET OR EXCEED DEPARTMENT OF ENERGY 2017 REQUIREMENTS.

OWP

Rev. Date	Rev. #	Rev. Title
7-31-18	2	NEW STANDARDS
12-1-17	1	DOE 2017



A DOVER COMPANY

SECOND NATURE DATA								
Case Model	No. of Coils	Application	Front Sill Type	BTUH/ft (DR)		GPM/ft (DR)	Supply Fluid Temp (F)	Discharge Air Temp (F)
				Conventional	Parallel			
OWP	1	Cut Produce	39" (Rear Sill)	298	277	0.16	20	36
OWP	1	Bulk Produce	39" (Rear Sill)	379	353	0.21	20	31
OWP	1	Cut Produce	43" (Rear Sill)	501	466	0.27	20	35
OWP	1	Bulk Produce	43" (Rear Sill)	538	501	0.29	20	30

SECOND NATURE DATA								
Case Model	No. of Coils	Application	Front Sill Type	No. of Defrost	Timed Off Defrost		Warm Fluid Defrost	
					Fail Safe (Min)	Termination Temp (F)	Fail Safe (Min)	Termination Temp (F)
OWP	1	Cut Produce	39" (Rear Sill)	4	60	47	26	49
OWP	1	Cut Produce	43" (Rear Sill)	4	60	47	26	49
OWP	1	Bulk Produce	39" (Rear Sill)	4	60	47	26	49
OWP	1	Bulk Produce	43" (Rear Sill)	4	60	47	26	49



ALL MEASUREMENTS ARE TAKEN PER ASHRAE-72-2005 SPECIFICATIONS. HILLPHOENIX REFRIGERATED DISPLAY CASES FOR SALE IN THE UNITED STATES MEET OR EXCEED DEPARTMENT OF ENERGY 2017 REQUIREMENTS.

## OWP

Rev. Date	Rev. #	Rev. Title
7-31-18	2	NEW STANDARDS
12-1-17	1	DOE 2017

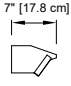
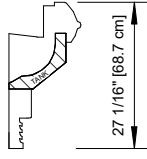
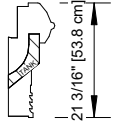
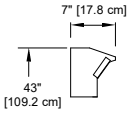
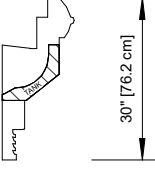
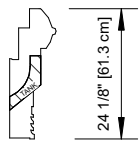
<u>REAR SILL OPTIONS</u>	<u>FRONT OPTIONS</u>	
	11" BASEFRAME	5" BASEFRAME
<u>STANDARD</u>  	<u>STANDARD FRONT</u>  	<u>STANDARD FRONT</u>  
<u>EXTENDED</u>  	<u>EXTENDED STANDARD FRONT</u>  	<u>EXTENDED STANDARD FRONT</u>  



COMPONENT

ALL MEASUREMENTS ARE TAKEN PER ASHRAE-72-2005 SPECIFICATIONS. HILLPHOENIX REFRIGERATED DISPLAY CASES FOR SALE IN THE UNITED STATES MEET OR EXCEED DEPARTMENT OF ENERGY 2017 REQUIREMENTS.

OWP

Rev. Date	Rev. #	Rev. Title
7-31-18	2	NEW STANDARDS
12-1-17	1	DOE 2017

**Hillphoenix**  
A DOVER COMPANY

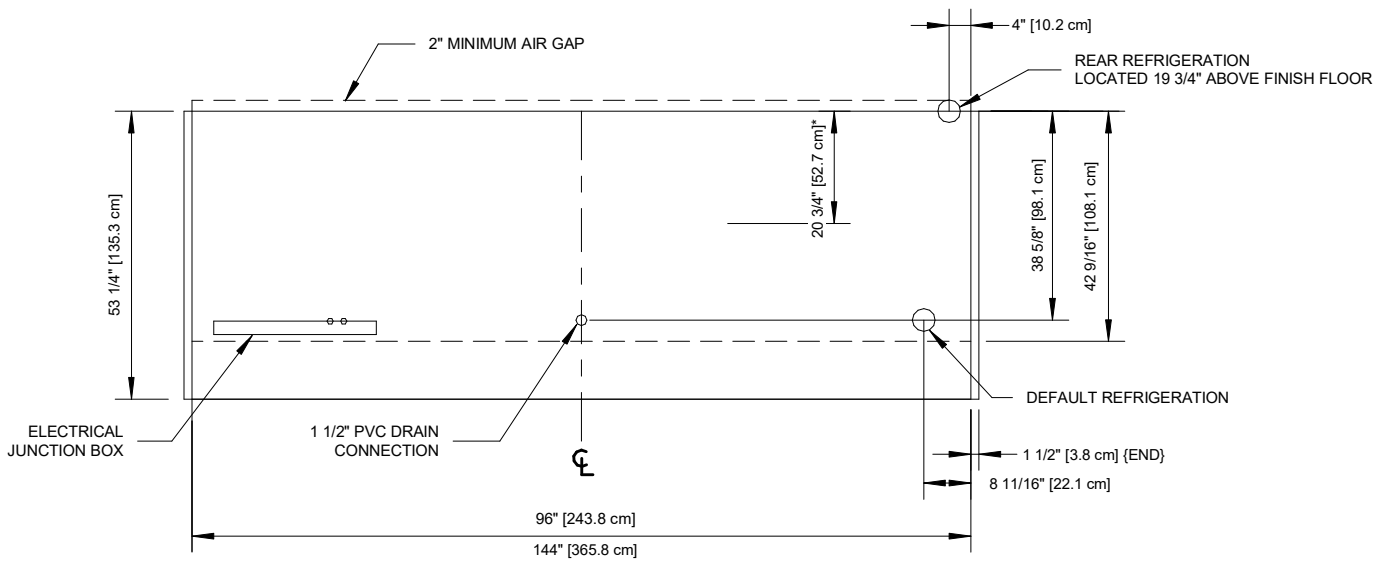
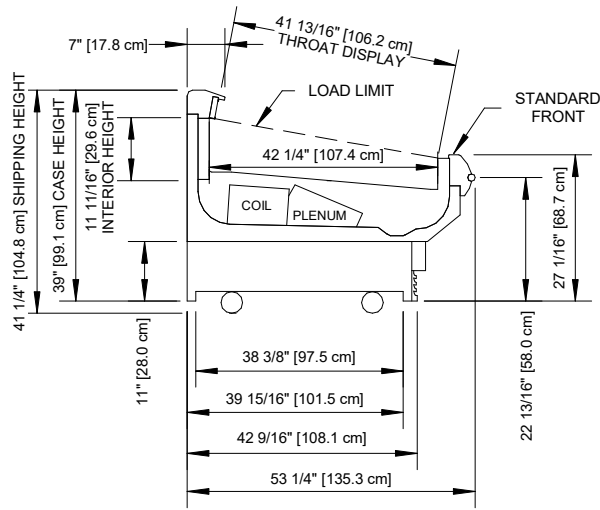

### NOTES:

- \* : STUB-UP AREA
- \*\* : RECOMMENDED STUB-UP CENTERLINE FOR ELECTRICAL AND HUB DRAINS

• Ends add approximately 1" to case height



COMPONENT

ALL MEASUREMENTS ARE TAKEN PER ASHRAE-72-2005 SPECIFICATIONS. HILLPHOENIX REFRIGERATED DISPLAY CASES FOR SALE IN THE UNITED STATES MEET OR EXCEED DEPARTMENT OF ENERGY 2017 REQUIREMENTS.

OWP

Rev. Date	Rev. #	Rev. Title
7-31-18	2	NEW STANDARDS
12-1-17	1	DOE 2017

**Hillphoenix**  
A DOVER COMPANY