

**Hillphoenix**

a **DOVER** company

**The  
SFC  
Group**

*Solutions for  
convenience sake*



**HVI-3-305SC-RAD/HVI-3-406SC-RAD**

## Self-Service Open Multi-Deck

Small-store format, refrigerated radius island merchandiser for bakery, beverage, dairy, deli and produce.

**Standard HVI-3-305SC**  
radius end caps with  
standard black finish.



**Base Model Features**

- Case dimensions without casters:
  - HVI-3-305SC:  
61-7/8"H, 36"D, 60"W
  - HVI-3-406SC:  
61-7/8"H, 48"D, 72"W
- Two full radius end caps.
- Case top: Deep Night Sky solid surface.
- Exterior: Powder-coated gloss black metal.
- Base trim: Powder-coated to match exterior.
- Interior: Powder-coated matte black metal with matching trim.
- Clearvoyant® 4 LED cornice and shelf lighting, 3000K.
- One row of 8" and 10" metal shelves powder-coated matte black.
- Integrated 1/2" product stop on each shelf.
- Shelves built with airflow chambers for superior product temperature holding capability.
- 5-1/2" die board plex.
- 2-1/2" product stop on deck shelf.
- 2 rows of cart bumpers.
- Standard digital temperature control with automatic defrost.
- Solar digital thermometer.
- Energy-efficient, electronic-controlled fan motors.
- Condenser intake front-to-back exhaust airflow.
- Intake filter with tool-free access for easy maintenance.
- Self-contained refrigeration.
- Electric dissipater pan.
- 6' UL cord and NEMA locking plug power connections included.
- Main power switch and light ON/OFF switches installed.
- Conforms to UL Standard 471, NSF Standard 7 and CAN/CSA C22.2.

**Optional HVI-3-305SC curved end caps with optional cherry wood laminante.**



## Available Options

- Case dimensions with casters:
  - HVI-3-305SC:  
63-9/16"H, 36"D, 60"W
  - HVI-3-406SC:  
63-9/16"H, 48"D, 72"W
- Two full curved ends.
- Exterior top and front panel with laminated overlay onto glossy black power-coated metal.
- Black plastic tag molding on shelves.
- 1-1/2" plex product stop on shelves.
- Lift gate shipping option.
- NEMA locking plug included with casters.

## Fast Facts...

- Airflow shelving creates multiple air curtains to improve product integrity and self-life, increasing sales.
- Case is designed for product to be held at 41° F or below.
- High-efficiency fan motor with oversized condenser coil easily handles adverse conditions a standard fan cannot.
- Fully balanced fan motor provides super-quiet operation.
- Designed to maximize energy efficiency and minimize operating costs.
- Clearvoyant® LED lighting has 360° adjustment, frosted lens and a variety of color temperatures to eliminate shadows and add "pop" to specialty items.
- Improved product presentation improves product sales.
- NEMA locking plug included with casters.

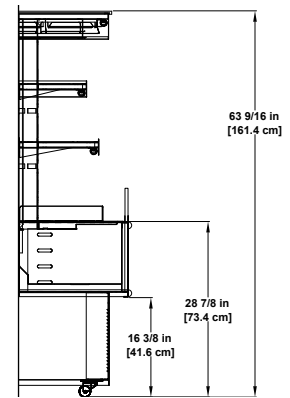

\_\_\_\_\_

# HVI-3-406SC-RAD

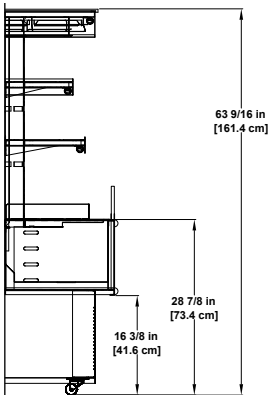
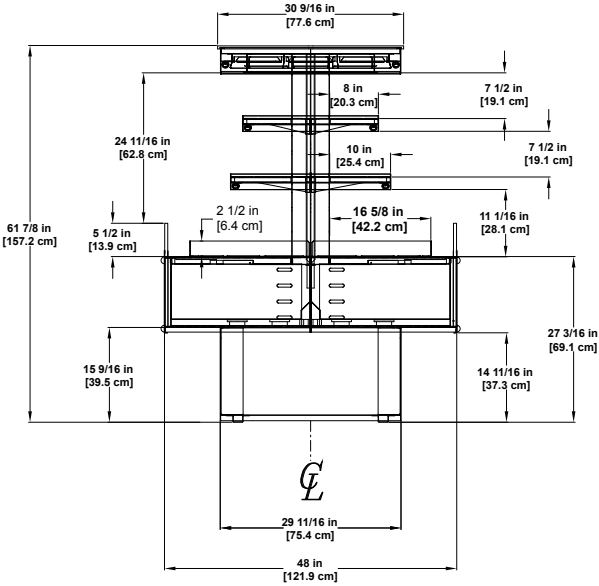

End view with optional casters shown.

## Standard Radius End Caps

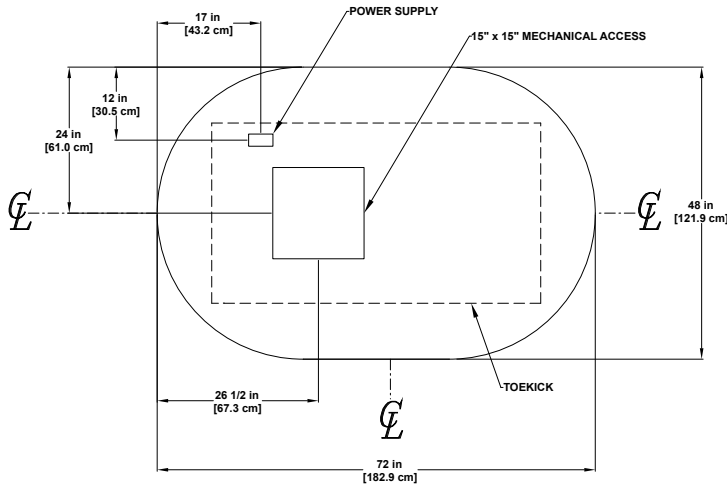

## Optional Curved End Caps

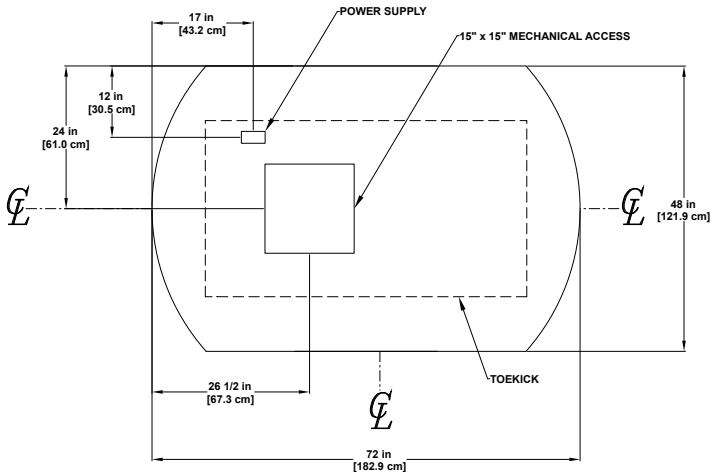



401364  
Wild Cherry

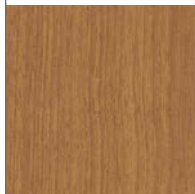

400995  
Cocoa Maple



400628  
African Limba



401392  
WA River Cherry

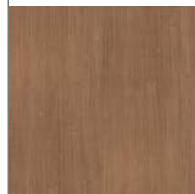

400624  
Natural Oak

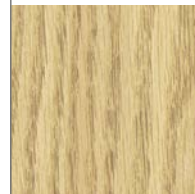

400634  
Natural Maple

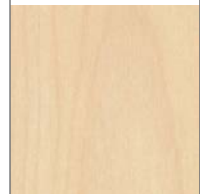



As beautiful on the outside as it is hard working on the inside, your end cap merchandiser has been designed to fit any store layout or decor. Simply choose from a wide variety of select wood laminates to add the finishing touch and your end cap merchandiser is ready to go to work!

## Featured Laminates

401245  
Planked Pear

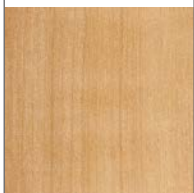

401302  
Macchiato Walnut

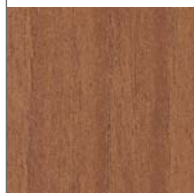

400968  
Prestige Walnut

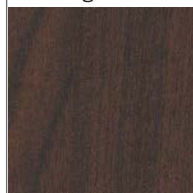

400997  
Natural Cherry

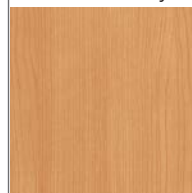

400678  
Select Cherry

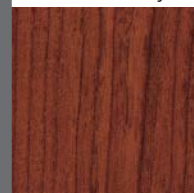

**Hillphoenix**

a **DOVER** company

2016 Gees Mill Road  
Conyers, GA 30013  
844.591.5937  
www.hillphoenix.com

©2018 Hillphoenix, Inc.



---

This case uses Synerg-E™ and Clearvoyant® proprietary technologies from Hillphoenix.