

GENERAL NOTES:

- Lighting Controls and Anti Sweat Heat Controls are Required
- Option 1: OEM Provided: Occupancy Sensor Based Lighting Controls (On/Off) & Hillphoenix provided embedded Anti Sweat Controls are standard, unless otherwise specified
- Option 2: End User Provided: Lighting Controls should be Occupancy Sensor Based or on a minimum 8 Hour Off Schedule. Customer provided A/S Heat Controls should be set to 30% minimum off time at 75°F/55%RH
- 2,3,4, & 5 door case lengths are available in 208V R448A Condensing Unit Configuration

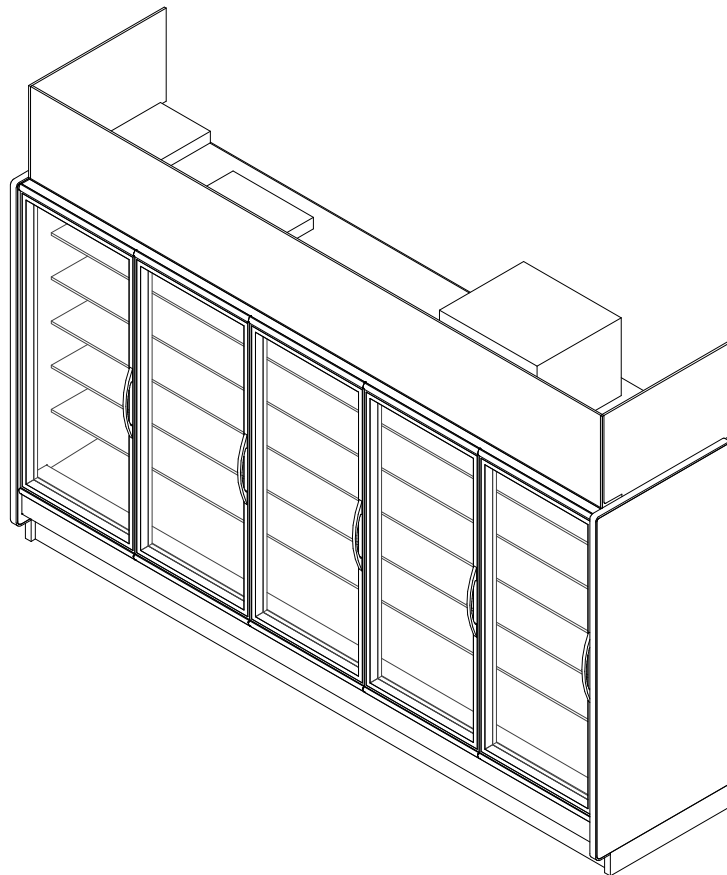

SHIPPING WEIGHT	
Case	Weight
JNRZHSA	---



ALL MEASUREMENTS ARE TAKEN PER ASHRAE-72 SPECIFICATIONS. HILLPHOENIX REFRIGERATED DISPLAY CASES FOR SALE IN THE UNITED STATES MEET OR EXCEED DEPARTMENT OF ENERGY 2017 REQUIREMENTS.

JNRZHSA

Rev. Date	Rev. #	Rev. Title
01-08-24	16	NOTES UPDATE
02-07-23	15	ENDVIEW UPDATE



SYSTEM REQUIREMENT (R448A)						
Case Length	Volts	Phase	Frequency (Hz)	Minimum Circuit Ampacity	Maximum Overcurrent Protection	24hr Energy Usage (kWh)
2 Door	208	1	60	17.9	20.0	20.1
3 Door	208	1	60	24.0	30.0	25.3
4 Door	208	1	60	25.4	30.0	34.4
5 Door	208	1	60	27.9	30.0	40.0

GUIDELINES AND CONTROL SETTINGS (R448A)				
Case Length	Superheat Set Point @ Bulb (°F)	Set Point Differential (°F)	Discharge Air (°F)	Discharge Air Velocity (FPM)
2 Door	3 - 5	4	- 9	250
3 Door	3 - 5	4	- 9	250
4 Door	3 - 5	4	- 9	250
5 Door	3 - 5	4	- 9	250

CONDENSING UNIT DATA (R448A)								
Case Length	Volts	Phase	Frequency (Hz)	Horsepower	Running Load Amps (RLA)	Locked Rotor Amps (LRA)	Refrigerant	Refrigerant (Lbs)
2 Door	208	1	60	1	6.5	40.0	R448A	4.0
3 Door	208	1	60	1 1/2	8.7	45.0	R448A	4.0
4 Door	208	1	60	2 1/4	9.1	74.0	R448A	4.75
5 Door	208	1	60	2 1/4	9.1	74.0	R448A	5.5

DEFROST CONTROLS (R448A)			
Defrosts Per Day	Electric Defrost		
	Run-Off Time (Min)	Fail-Safe (Min)	Termination Temp (°F)
1	0	46	48

DEFROST SCHEDULE (R448A)	
Defrosts Per Day	Time
1	12 midnight

NOTES:

- "-" indicates that this feature is not an option on this case model.
- Listed discharge air velocity represents the average velocity at the peak of defrost using a Testo 410i Anemometer.
- Temperature and defrost settings listed below are recommended start-up settings. Final operational settings may need to be adjusted for the store conditions in which the case operates.
- The recommended evaporator temperatures may need to be adjusted based on system setup, store conditions, etc. The minimum recommended evaporator temperature is 4°F below the listed evaporator temperature.
- The 24 Hour Energy Value is based upon AHRI 1200 test conditions with Hillphoenix provided evaporator fans, condensing unit, LED lights, occupancy sensor based (on/off) lighting control, dew point based anti-sweat heat controller, condensate pump, evaporator pan, heated door frame, and heated glass doors/electric defrost on low temp cases.
- Discharge air temperature values represent readings taken within the upper air channel immediately behind/upstream of the honeycomb.
- For optimal performance in HFC applications, it is recommended to close the liquid line and close the suction line during defrost. Defrost parameters may need to be adjusted if other methods are used.



ALL MEASUREMENTS ARE TAKEN PER ASHRAE-72 SPECIFICATIONS. HILLPHOENIX REFRIGERATED DISPLAY CASES FOR SALE IN THE UNITED STATES MEET OR EXCEED DEPARTMENT OF ENERGY 2017 REQUIREMENTS.

JNRZHSA

Rev. Date	Rev. #	Rev. Title
01-08-24	16	NOTES UPDATE
02-07-23	15	ENDVIEW UPDATE



A DOVER COMPANY

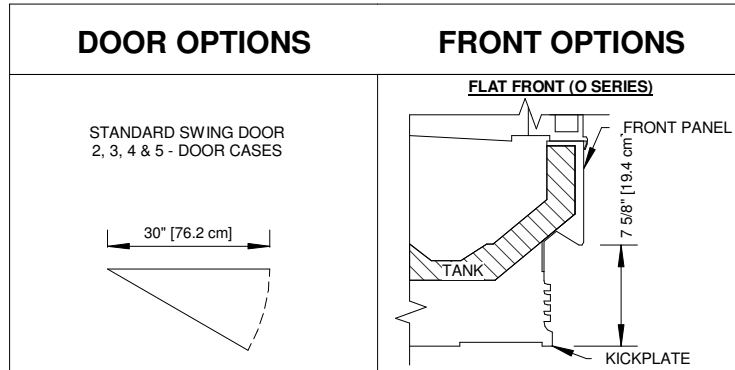

ALL MEASUREMENTS ARE TAKEN PER ASHRAE-72 SPECIFICATIONS. HILLPHOENIX REFRIGERATED DISPLAY CASES FOR SALE IN THE UNITED STATES MEET OR EXCEED DEPARTMENT OF ENERGY 2017 REQUIREMENTS.

JNRZHSA

Rev. Date	Rev. #	Rev. Title
01-08-24	16	NOTES UPDATE
02-07-23	15	ENDVIEW UPDATE

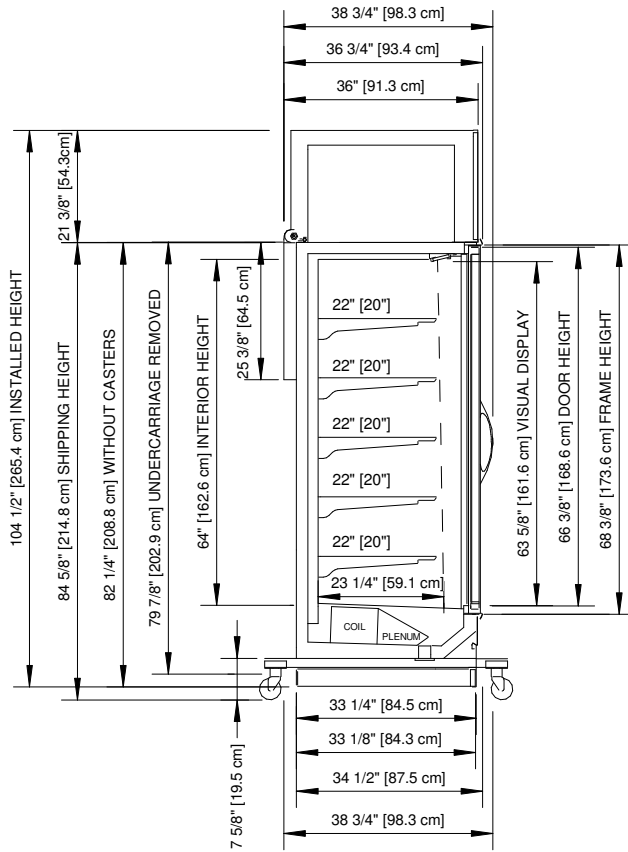

CONDENSING UNIT SIZE AND POSITION R448A				
CASE LENGTH	2DR	3DR	4DR	5DR
"X"	23"	23"	23"	23"
"Y"	6"	6"	6"	6"
"A"	21.0"	21.0"	24.0"	24.0"
"B"	16.0"	16.0"	24.0"	24.0"

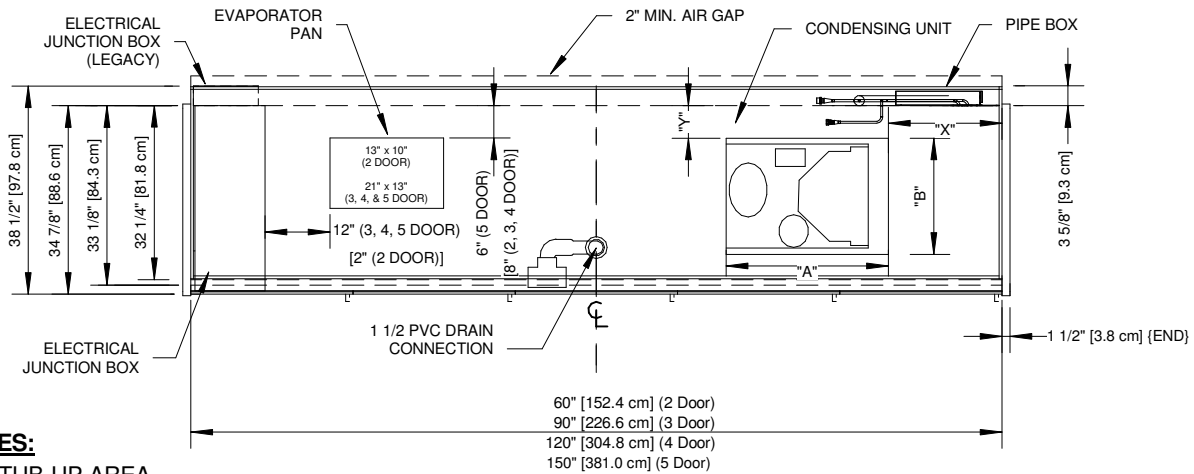

NOTES:

- * : STUB-UP AREA
- ** : RECOMMENDED STUB-UP CENTERLINE FOR ELECTRICAL AND HUB DRAINS

- Specialized Base Frame.
- Case fits through 80" doorway in the as shipped configuration with 2" fork lift brackets.
- 2" lifting brackets (installed) & 3.25" ship loose risers combine for 5" baseframe once installed.
- Drain traps ship loose.
- Ends add approximately 1" to case height, 1/2" to the back & 1" to the front.



JNRZHSA

ALL MEASUREMENTS ARE TAKEN PER ASHRAE-72 SPECIFICATIONS. HILLPHOENIX REFRIGERATED DISPLAY CASES FOR SALE IN THE UNITED STATES MEET OR EXCEED DEPARTMENT OF ENERGY 2017 REQUIREMENTS.

Rev. Date	Rev. #	Rev. Title
01-08-24	16	NOTES UPDATE
02-07-23	15	ENDVIEW UPDATE

